

Board of Trustees

December 2, 2016

Background and Data



Agenda

1. **Current Status on Facilities Master Plan Process**
2. **Facility Assessments-Setting the Weighting Factor**
3. **Demographics ?**
4. **Survey Results**
 - **Community Survey**
 - **Staff Survey**
5. **Focus Group Meetings**
 - **Who attended?**
 - **<http://www.sanjuan.edu/domain/7783> The UNSCHOOL**
 - **The Portable project at Tumbleweed**
6. **Guiding Principals**
7. **Quick Start Project List**

Current Status – MP Process

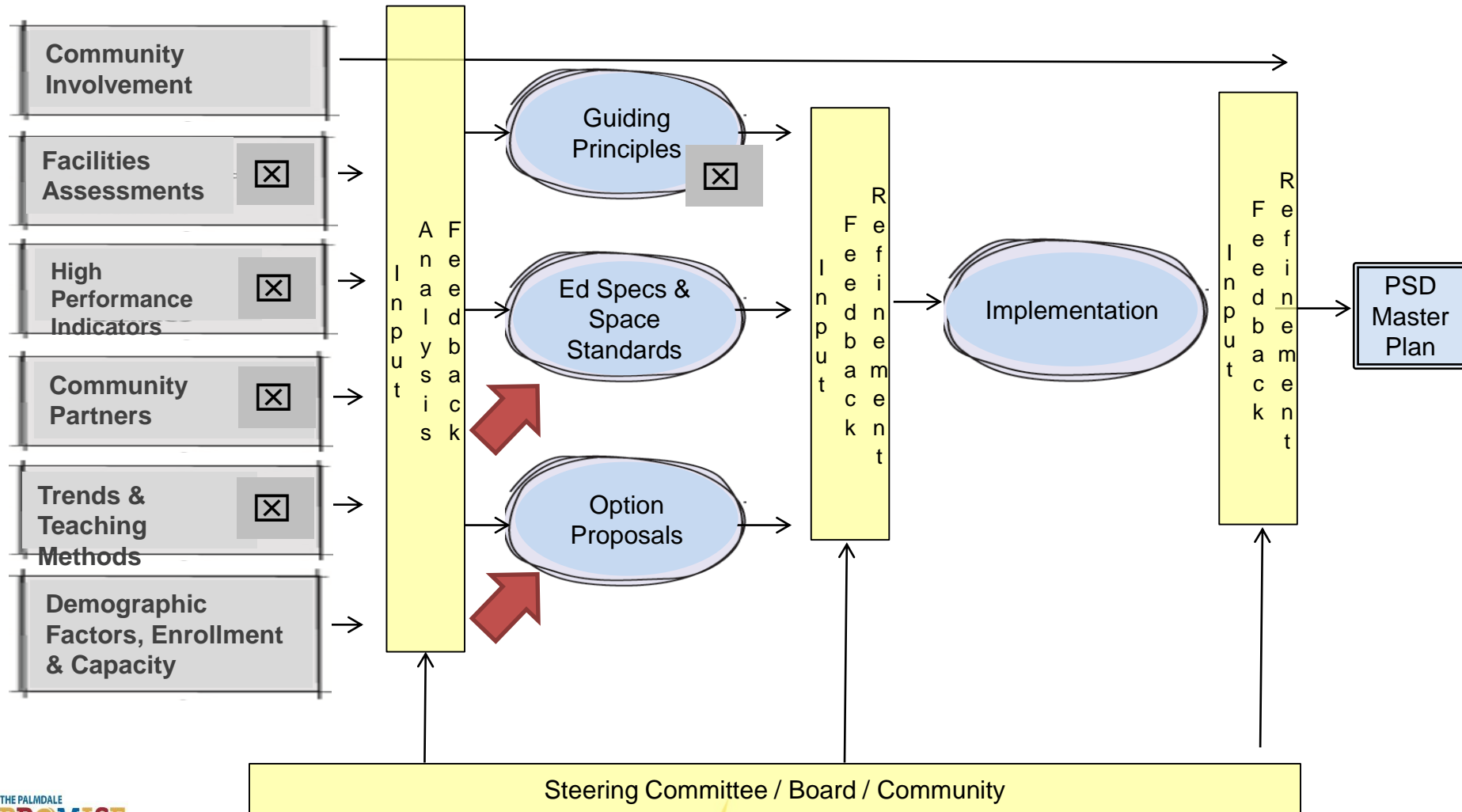

Facility Assessments



Every campus was assessed
from 5 different perspectives

Building Functionality Assessment

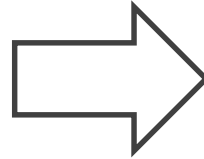
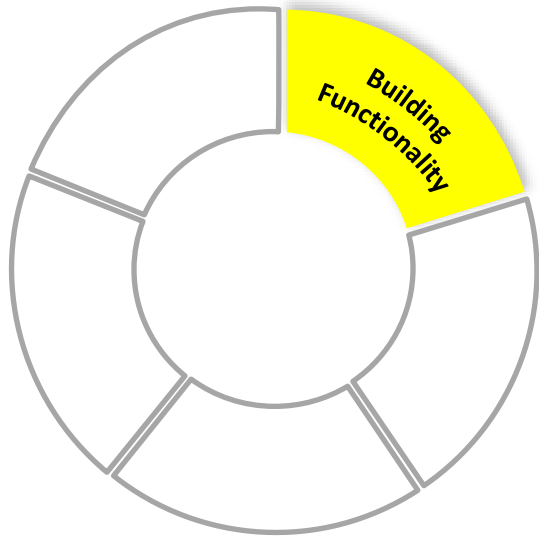

Items assessed included the following:

1. Activity Zone Design
2. Size
3. Technology
4. Special Utilities
5. Storage
6. Electrical Outlets
7. Equipment

Each building's score is proportionately weighted based on their square footage

Building Condition Assessment

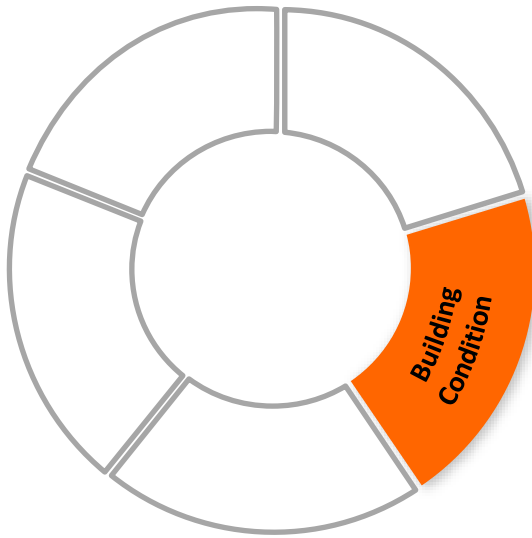

Items assessed included the following:

1. Windows
2. Ceiling
3. Flooring
4. Doors
5. HVAC
6. Electrical Infrastructure
7. Interior and Exterior Finishes

Each building's score is proportionately weighted based on their square footage

Building Key Performance Indicators Assessment

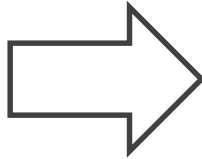
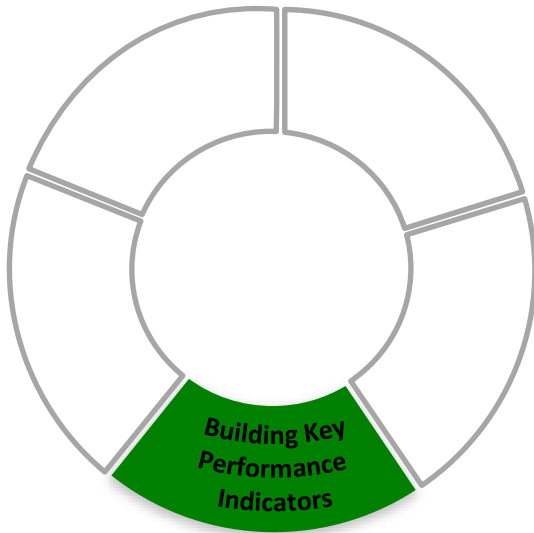

Items assessed included the following:

1. Indoor Air Quality
2. Ventilation
3. Temperature Control
4. Daylighting
5. Lighting
6. Views
7. Furniture
8. Color Appearance
9. Collaborative Spaces
10. Professional Work Spaces
11. Acoustics

Each building's score is proportionately weighted based on their square footage

Site Functionality Assessment

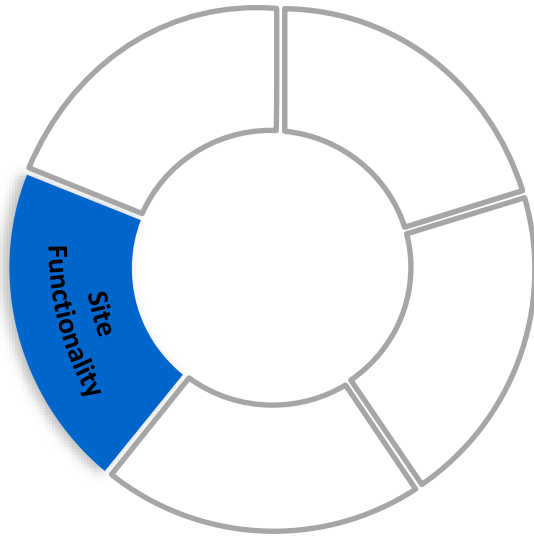

Items assessed included the following:

1. Parking Spaces
2. Drop Off
3. Bikes and Walkability
4. Adjacencies
5. Identified and Controlled Front Entrance
6. Hidden Spaces
7. Outdoor Seating
8. Grass Fields
9. Equipment
10. Hardcourt
11. Track
12. Bleachers

Site functionality is assessed once per campus

Site Condition Assessment

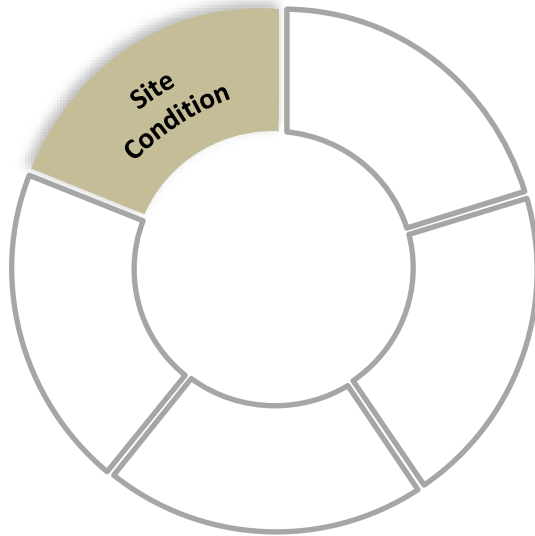

Items assessed included the following:

1. Fire Alarm
2. Bell Clock
3. Technology
4. Hydraulic
5. ADA

Site condition is assessed once per campus

Proposed Weighting Criteria

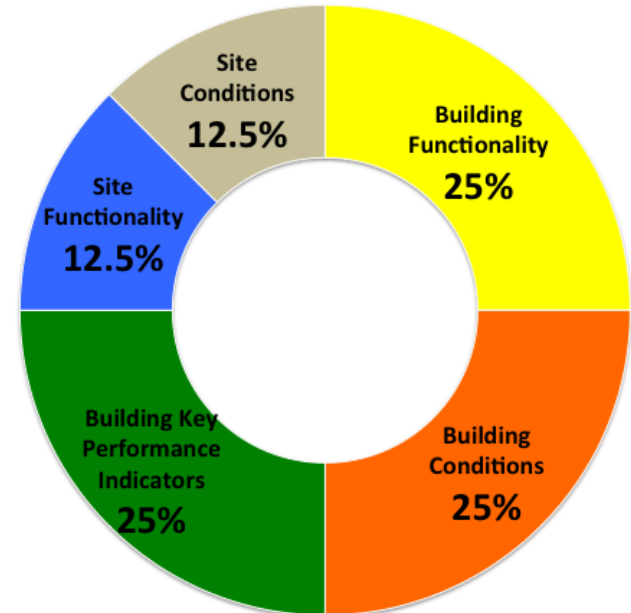
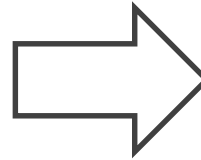
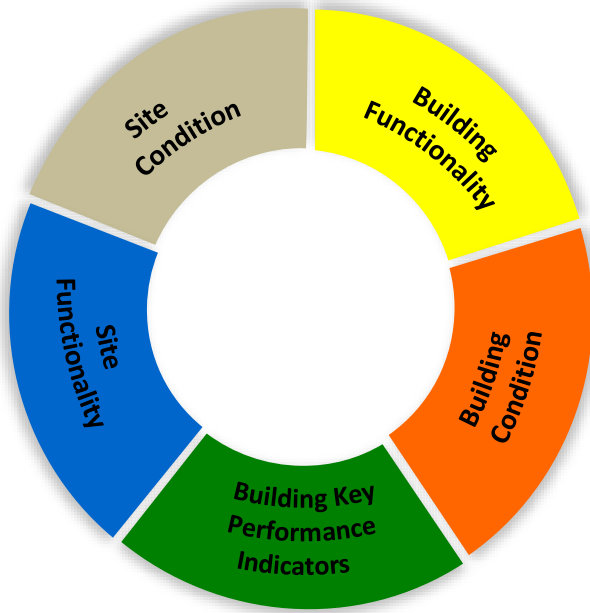

Proposed Weighting Criteria

Building Functionality	25.00%
Building Conditions	25.00%
Building Key Performance Indicators	25.00%
Site Functionality	12.50%
Site Conditions	12.50%
Total	100.00%

Weighted
Campus
Score



Example of Application – Tumbleweed Elementary

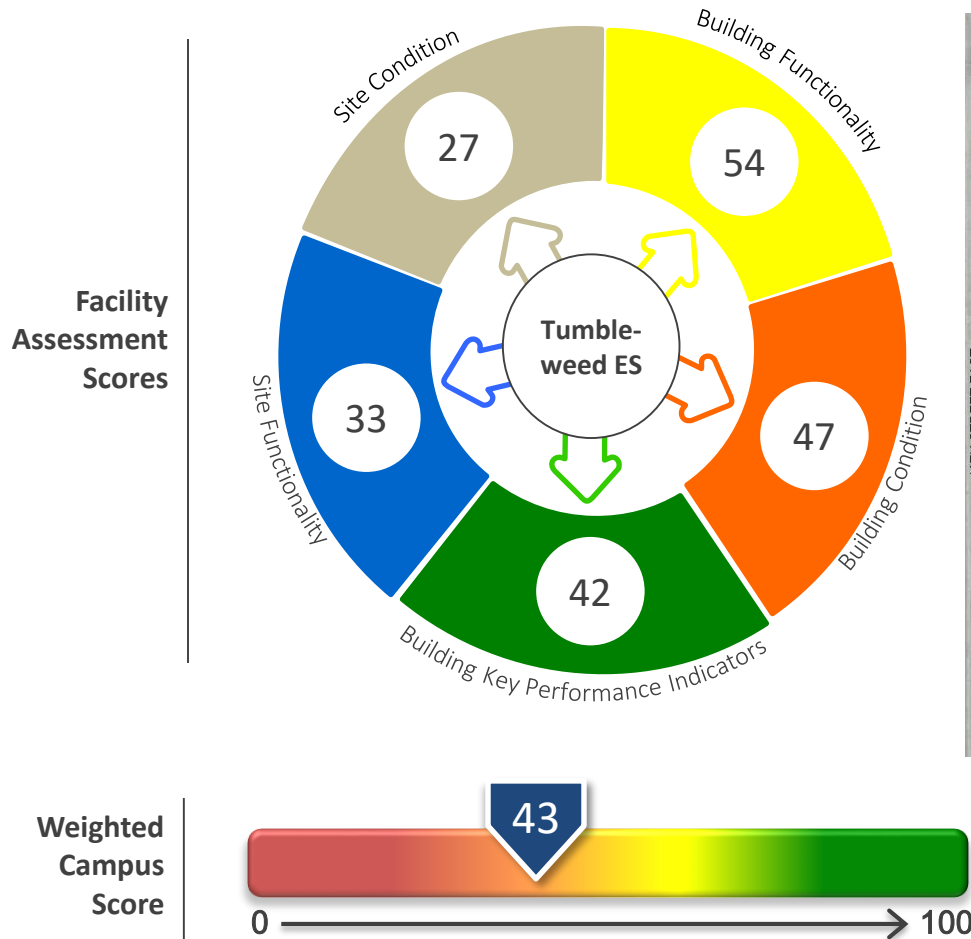

Demographics

District Survey Responses

What is your relationship to the Palmdale School District? (125 responses)

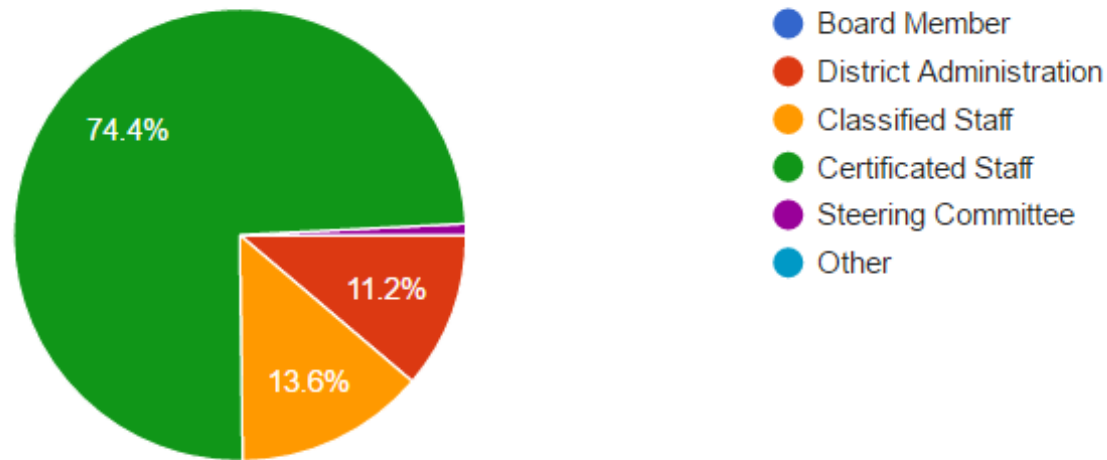

Fulling the Palmdale Promise

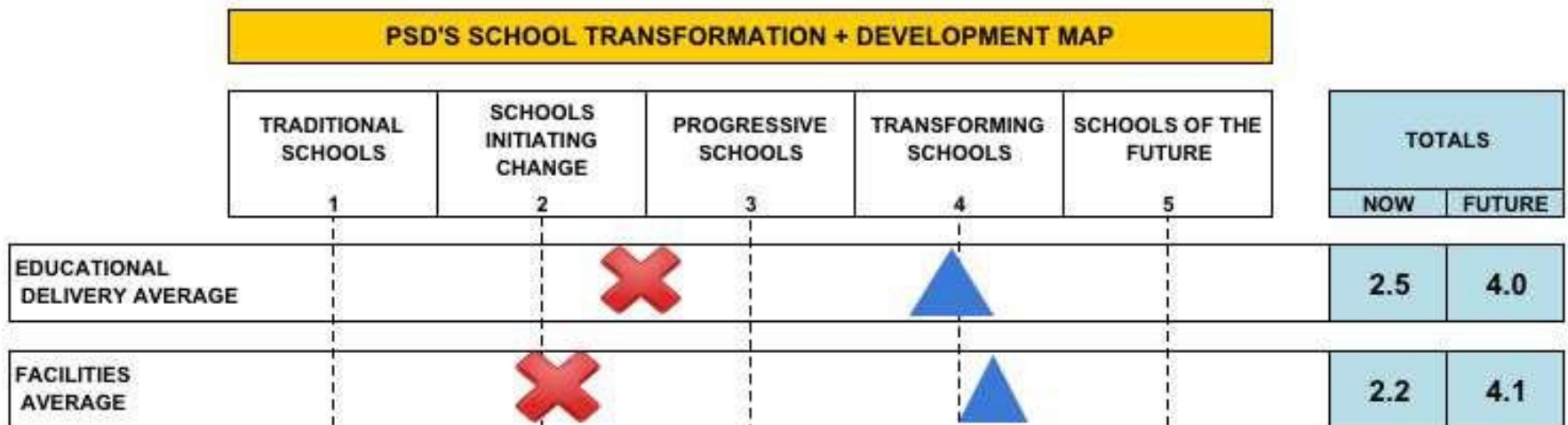

District Survey Results

How would
Personalized
Learning Plans
affect how you
operate?

In terms of PERSONAL LEARNING, which of the following do you think generally represents PSD schools?

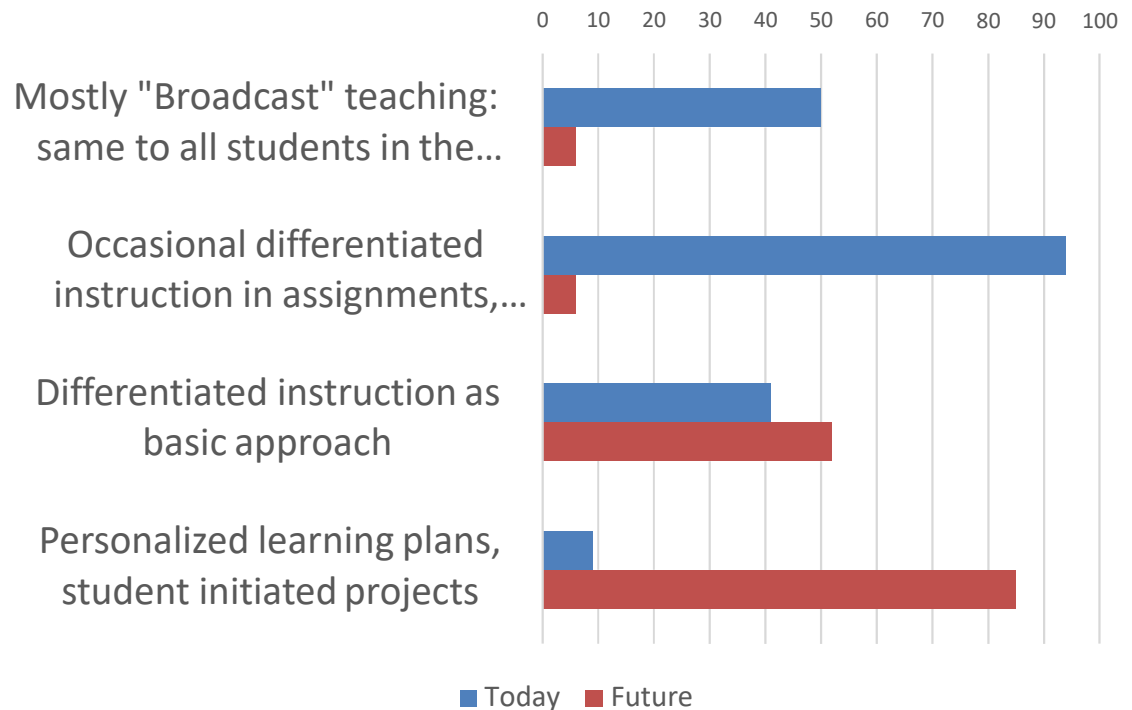

District Survey Results

What would schools look like without the self contained classroom model?

In terms of TEACHING TEAMS, which of the following do you think generally represents PSD schools?

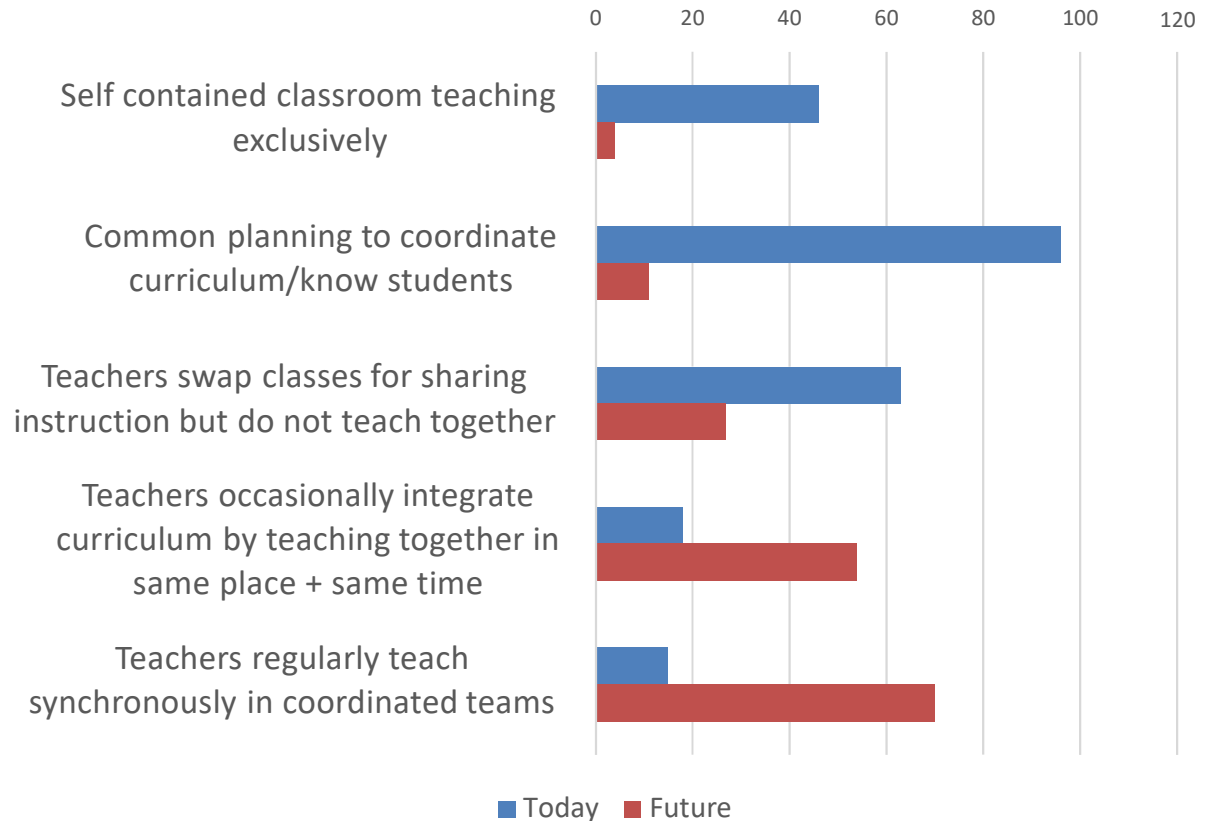

District Survey Results

What would
makeup a
suite?

In terms of CONNECTING SPACES, which of the following
do you think generally represents PSD schools?

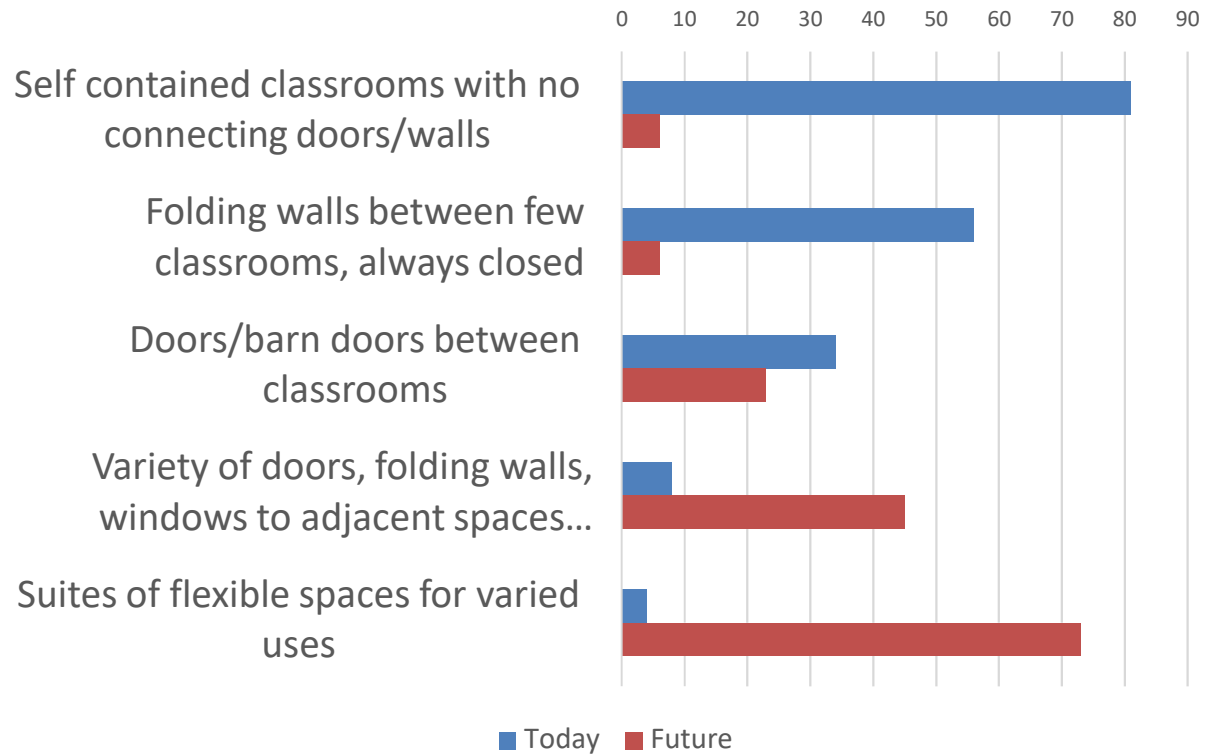

Many thought your schools should have...

- Art Space
- Small Group Space
- Individual Student Space
- Teacher Collaboration Space
- Lab Space
- Parent Space

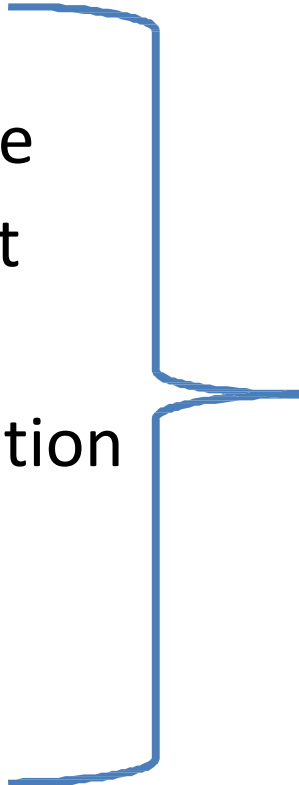

To gain all of these, what are you willing to modify?

Focus Groups

Elementary Project Based Learning

Kelly Jensen
Roxanne Dashti
Yesenia Diaz

English/Math/History

John Bowlin
Chris Vanderzee
Dan Michels
Stacy Bryant

Art

Alan Fox

Physical Education

Gail Degen
Rick Myers
Craig Nystrom

Early Education Meeting

Roxanne Dashti
Kelly Jensen
Carol Black
Donna Lebetsamer

Primary

Kelly Jensen
Kathy Wehunt
Ryan Beardsley
Susitna Wilkerson
Roxanne Dashti

Science

Jorge Maldonado
Melissa Contri
Mark Weiss
Ed Warren

Special Ed

Emily Malan
Chris Riley
Sue Stenstrum

Federal and State Programs

Frances Ufodu
Geoff Brown
Janet Simons

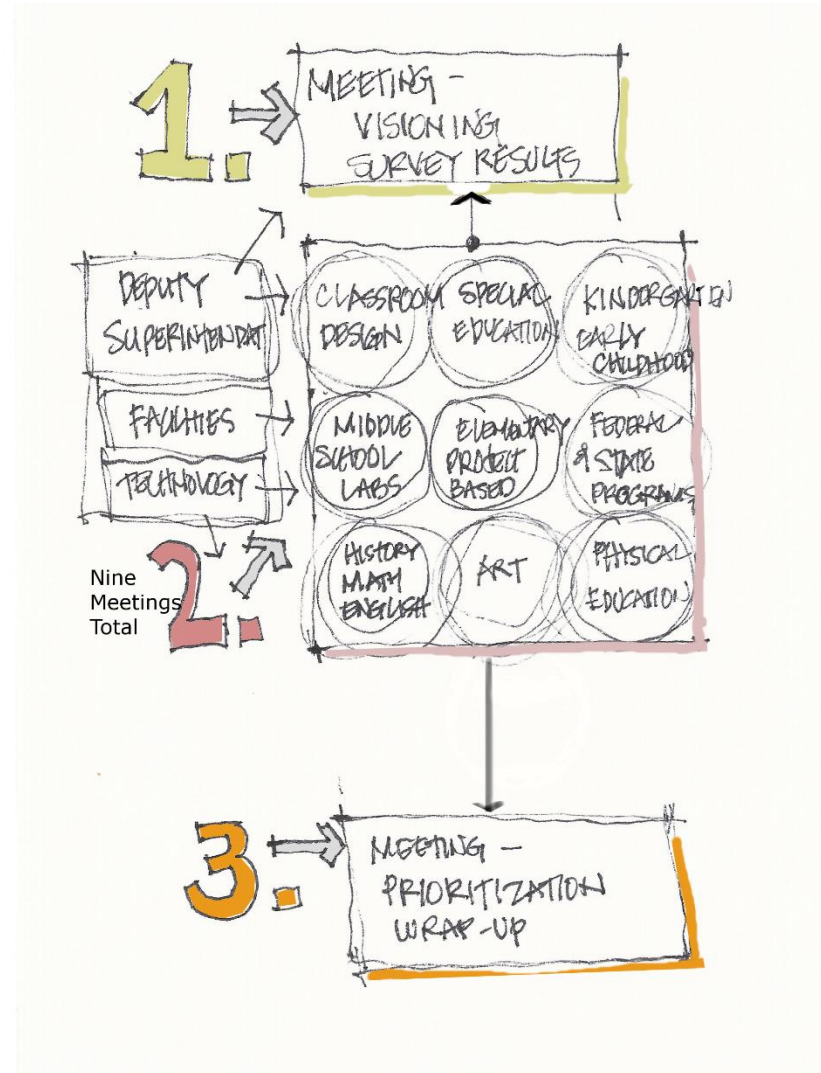

Focus Groups

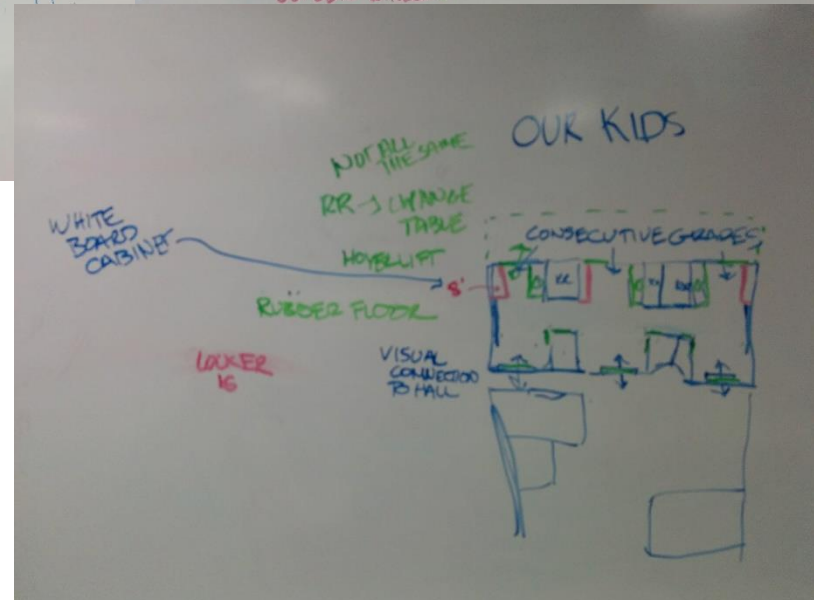
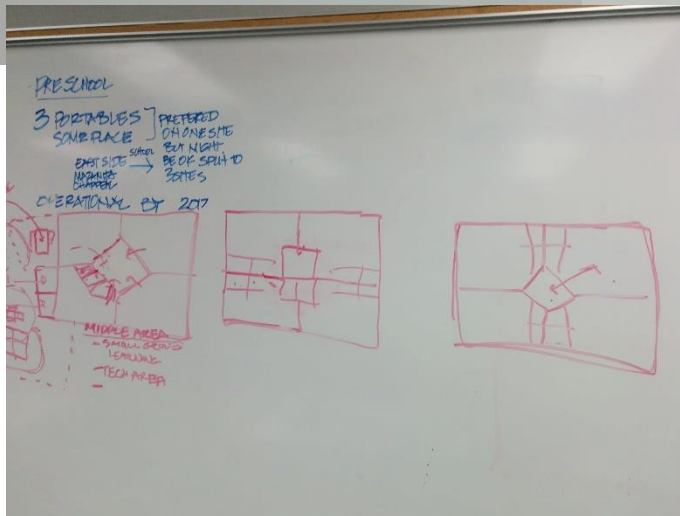
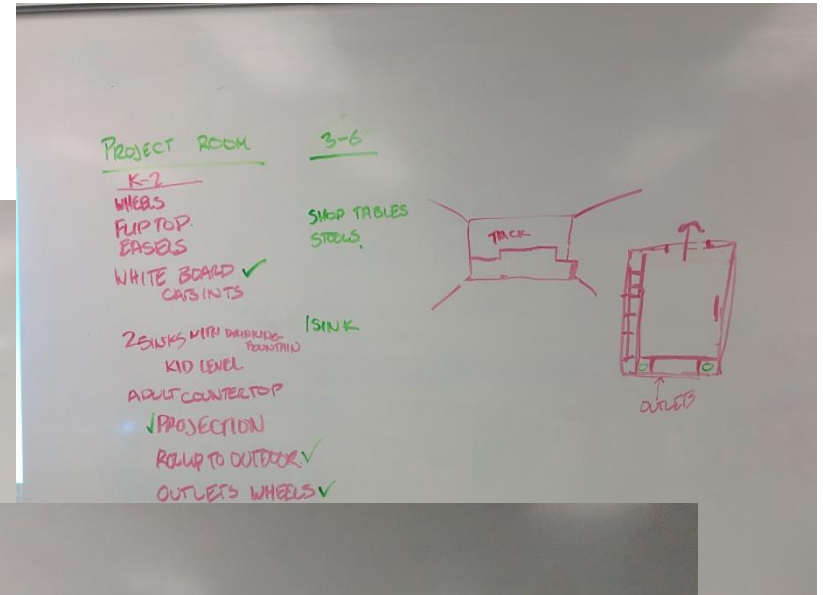
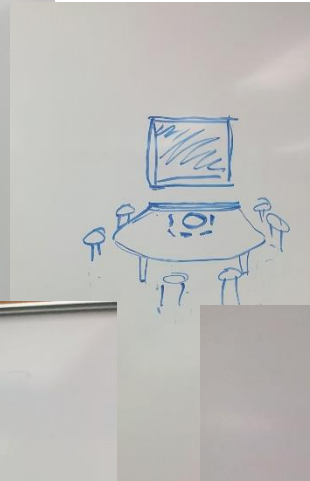
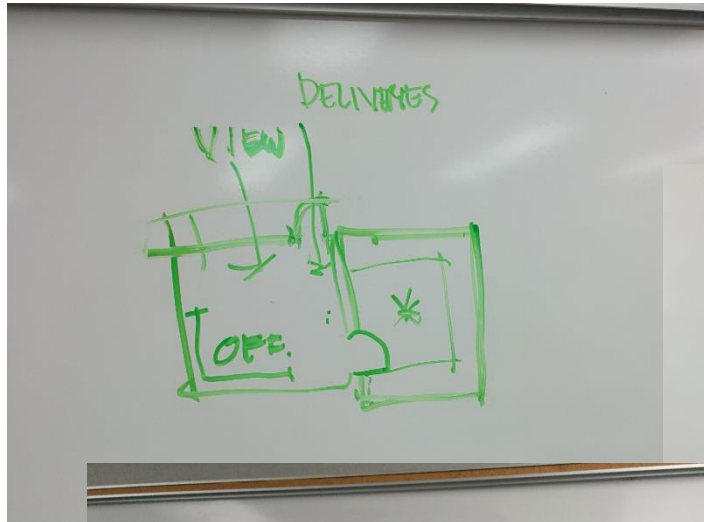

What is an Educational Specification?

School Facilities Planning – California Department of Education

- Linking Design of School Facilities to the Educational Program
- Form follows function
- The school facility does more than housing the program; it is part of the program
- They are the vehicle the architect uses to translate the curriculum and the instructional program into a beautiful, economical, functional educational environment

Traditional Model



- Desk/Table for every student
- Teacher Desk
- Elmo and projector cart with front table
- Class Library
- Small group area
- Technology center
- Calendar/site words/vocab wall
- Rug seating
- Science project on the back counter
- Project Building and Art supplies
- Math manipulatives
- Letter cards

One box, One Teacher, One Class

**ALL
USES**

And Repeat for Elementary

The Only Alternative Spaces

Parent
Room

Office

Library

MPR

Computer
Lab

Traditional Classroom - Primary

- Main Table Seating
- Rug Seating
- Small Group Area / Project Area
- Library Area
- Individual Seating
- Faculty Area
- Movable Storage
- Fixed Storage

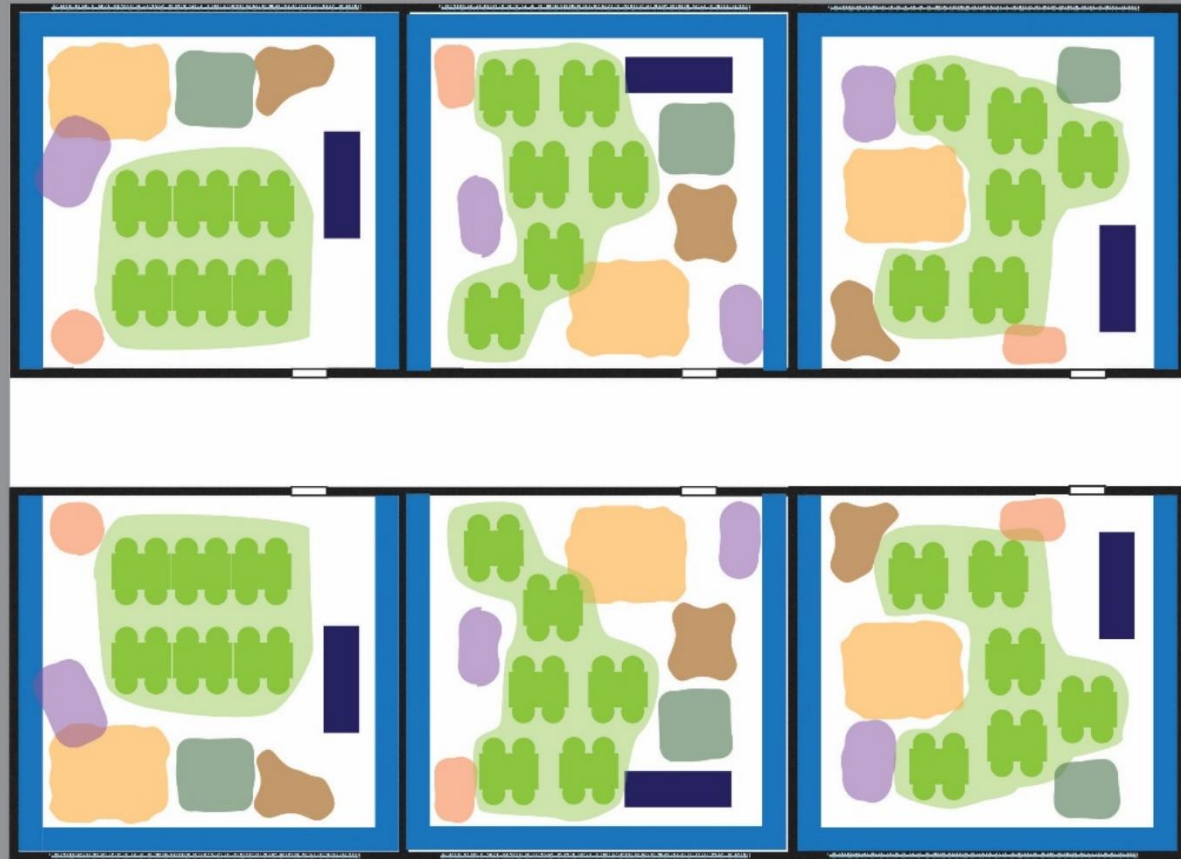

By Space Type

- Main Table Seating
- Rug Seating
- Small Group Area / Project Area
- Library Area
- Individual Seating
- Faculty Area
- Movable Storage
- Fixed Storage



2 Classroom Option

- Main Table Seating
- Rug Seating
- Small Group Area / Project Area
- Library Area
- Individual Seating
- Faculty Area
- Movable Storage
- Fixed Storage

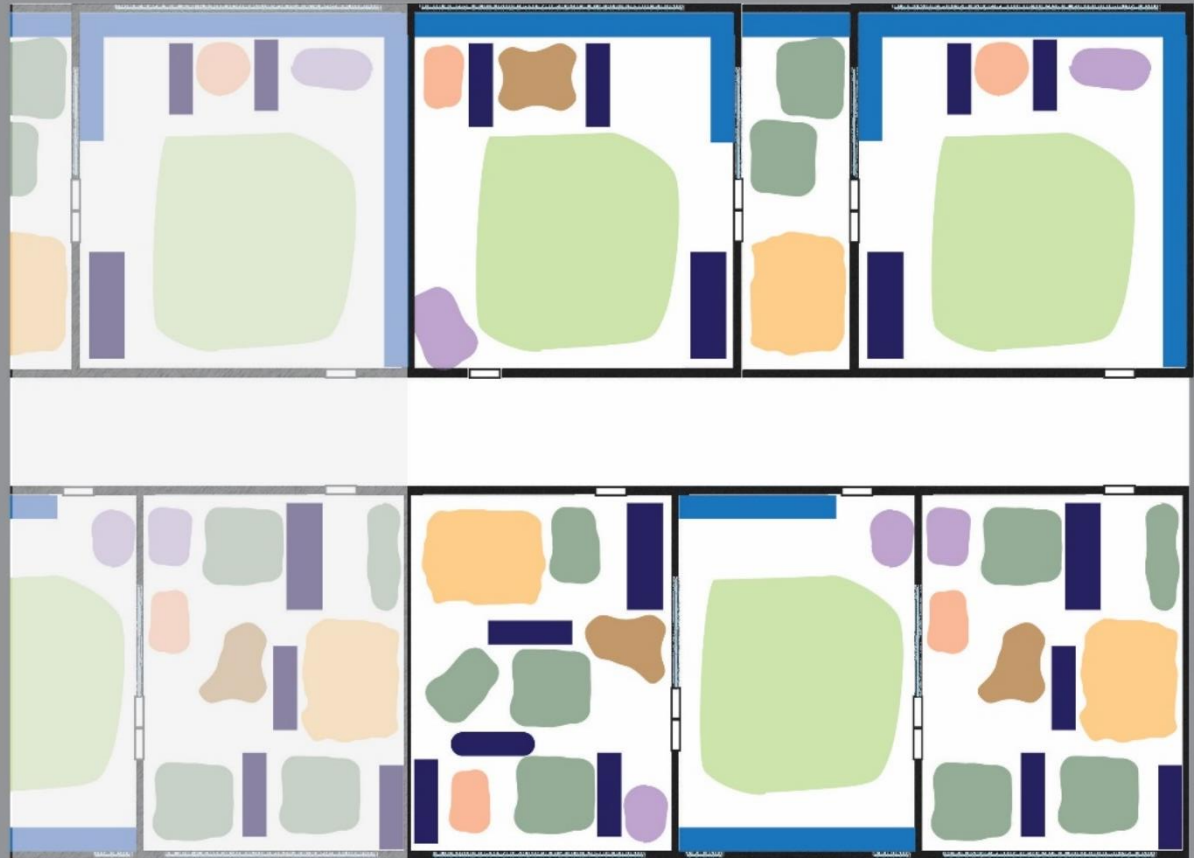

Teaching Suite

- Main Table Seating
- Rug Seating
- Small Group Area / Project Area
- Library Area
- Individual Seating
- Faculty Area
- Movable Storage
- Fixed Storage

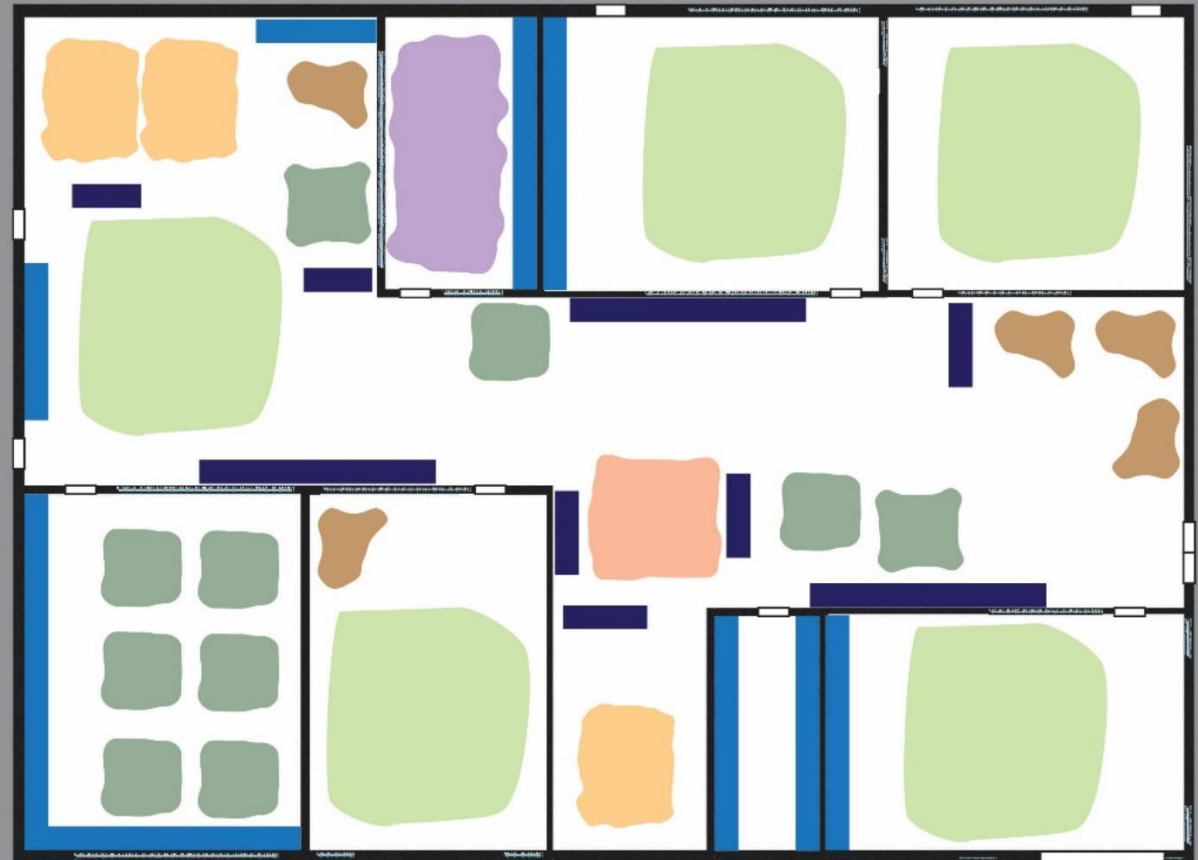

Organizational Styles for Middle

Departmental

Houses

By Grade

By Academy

By Multi-Grade Community

Traditional Classrooms - Middle

- Main Table Seating
- Standing Tables / Bar
- Small Group Area / Project Area
- Library Area
- Individual Workspaces
- Faculty Area
- Movable Storage
- Fixed Storage

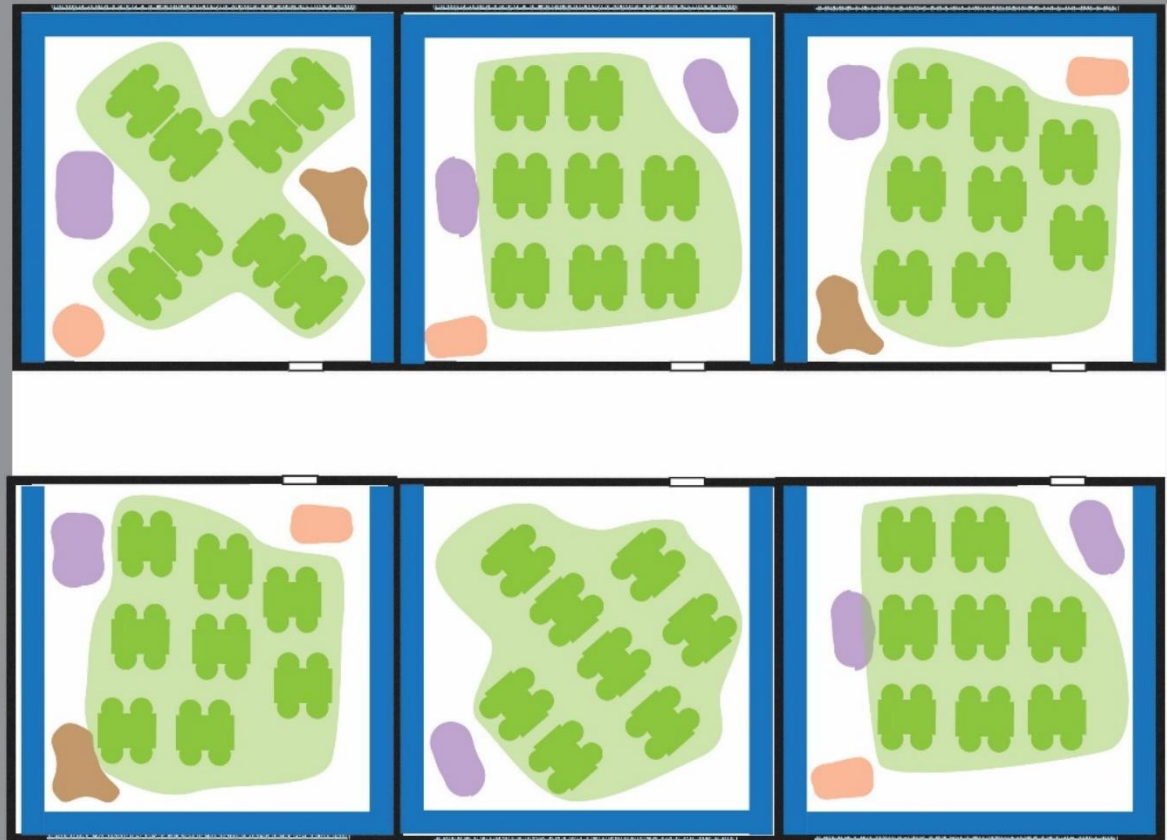

By Space Type

- Main Table Seating
- Standing Tables / Bar
- Small Group Area / Project Area
- Library Area
- Individual Workspaces
- Faculty Area
- Movable Storage
- Fixed Storage

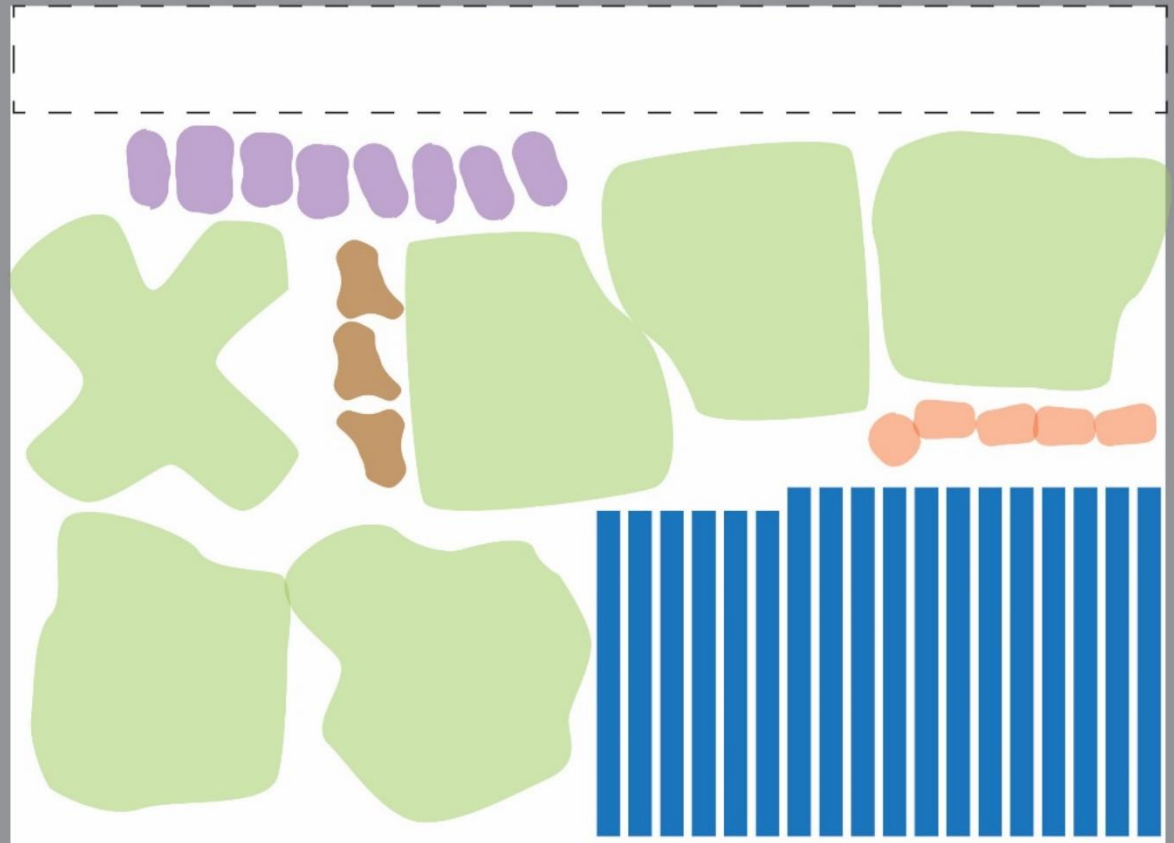

2 Classroom Options

- Main Table Seating
- Standing Tables / Bar
- Small Group Area / Project Area
- Library Area
- Individual Workspaces
- Faculty Area
- Movable Storage
- Fixed Storage



Teaching Suite

- Main Table Seating
- Standing Tables / Bar
- Small Group Area / Project Area
- Library Area
- Individual Workspaces
- Faculty Area
- Movable Storage
- Fixed Storage



Portable - Tumbleweed

Guiding Principals

Create a Facilities Vision to support Palmdale Promise

This Trip:

- Distilling the Promise
- Daring to change the image of “school” and “classroom”
- Experiencing Examples

Next Steps:

- Expanding the conversation
- Returning with input, more thoughts
- Creating Guiding Principals for the Master Plan
- Apply the Guiding Principals to the Master Plan Process through Option Development, Prioritization and the creation of Standards

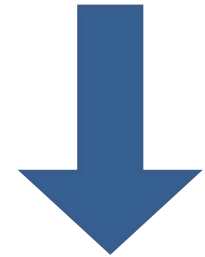

Application of the Palmdale Promise

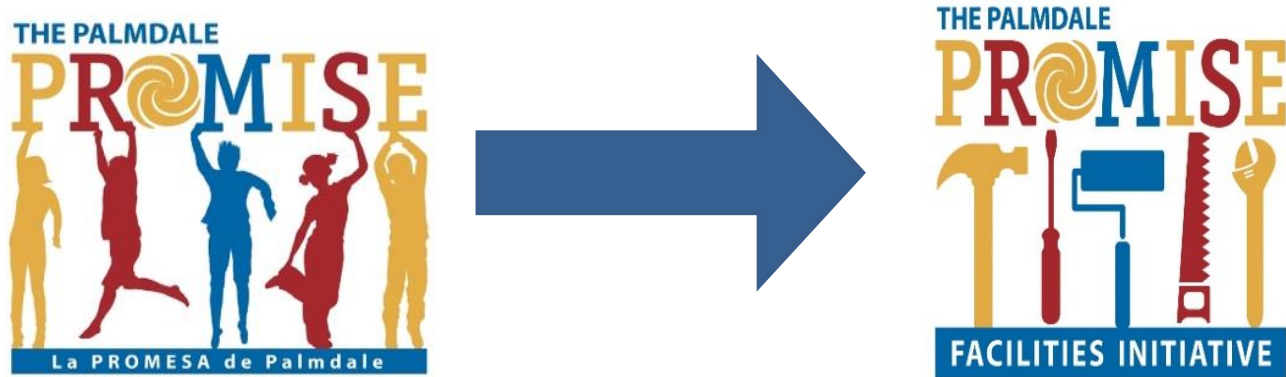

How do we create a facilities vision of the Palmdale Promise?

- Engagement
- Multicultural & Diverse
- Innovative & Creative
- Empowerment & Leadership

Creating a Facilities Vision



STUDENT SUCCESS

- *High-Level Academic Preparation*
- *College and Career Readiness*
- *Mastery of Advanced Literacies and 3M Skills (Multimedia, Multilingual, and Multicultural)*
- *Innovation, Creativity, and Solution Seeking Competencies*
- *Social, Civic, and Environmental Responsibility*
- *Technological Fluency*
- *Strength of Body, Mind, and Character*

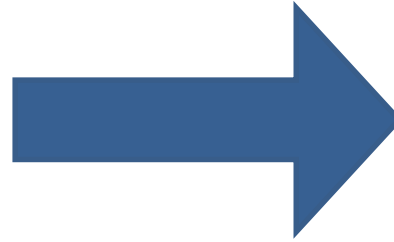

To accomplish these goals for Student Success what does a facility need to have?



Guiding Principals



GUIDING PRINCIPLES



PSD'S VISION

Palmdale will become a district where . . . Every Student Leaves Ready for Success in High School and Beyond: College, Career, the Global World.

PSD FACILITIES GOALS

The Palmdale School District facilities master plan will create a roadmap that produces globally competitive learning environments for every student.

OUR GLOBALLY-COMPETITIVE FACILITIES WILL HELP

DEVELOP

High Level Academic Preparation

Social, Civic, & Environmental Responsibility

Technological Fluency

Strength of Body, Mind, and Character

College & Career Readiness



HOW DO WE ACHIEVE THIS?

High Level
Academic
Preparation

College
& Career
Readiness

1	Provide Spaces Adaptable to many activities and learning styles with associated support amenities
2	Create Learning Environments with optimal learning conditions through the use of High Performance Design Practices
3	Engage Students with Welcoming, Comfortable, Flexible and Collaborative spaces with opportunities for exploration and innovation
4	Provide display areas to exhibit student work

DRAFT

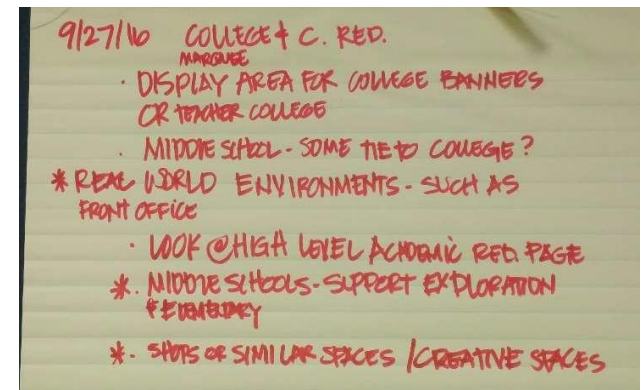
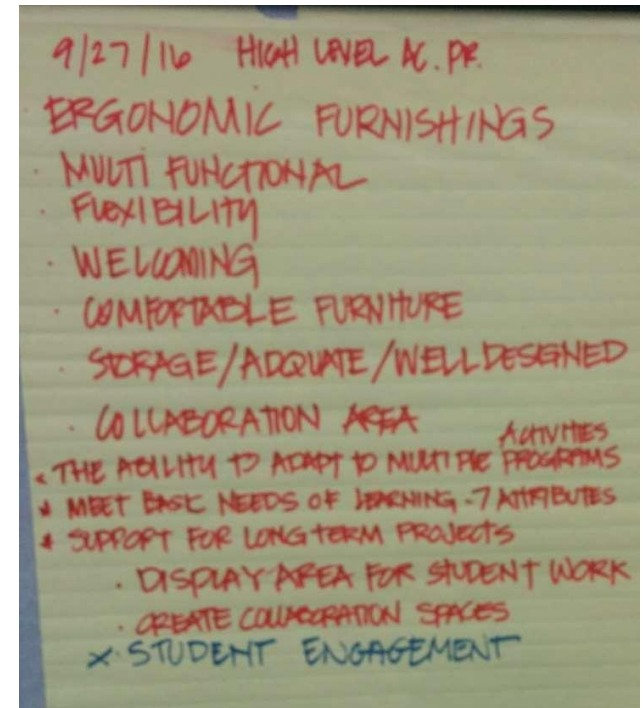

HOW DO
WE
ACHIEVE
THIS?

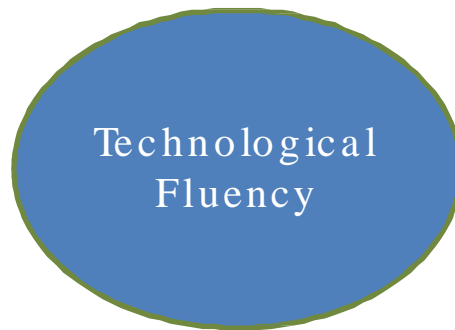

DRAFT

1	Provide a Comprehensive Electrical and Data Infrastructure to Support Educational Technology
2	Provide flexible structural supports which allows technology equipment to be easily updated.
3	Create space that allow students, staff and parents to deepen their understanding of the potential of technological tools

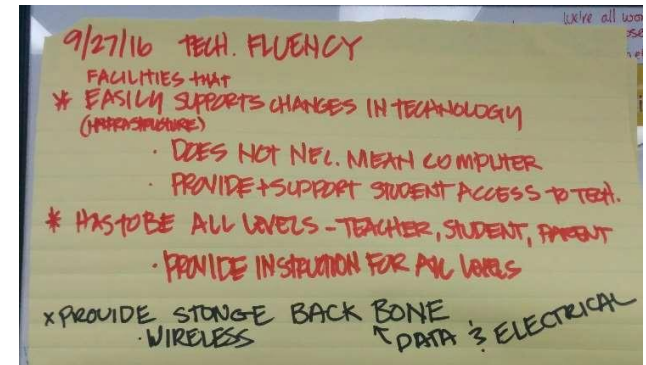

HOW DO WE ACHIEVE THIS?

Social, Civic, & Environmental Responsibility

Strength of Body, Mind, and Character

1	Provide Attractive and Safe Buildings and Grounds that foster Ownership, create Pride, and enhance the Community Image
2	Create Quality Indoor and Outdoor Facilities that support Active Students and Community Use, which are appropriate for Palmdale's Climate
3	Use Sustainable Construction Practices reducing energy, water and waste

DRAFT

9/27/16 S. CIVIC. ENV. RESP.

- LOOK / AESTHETICS
- OUTSIDE GROUPS- USE
- PLAY GROUNDS
- * SUPPORTS MULTIPLE SCHOOL + COMMUNITY ACTIVITIES
- * COMMUNITY USE OF (FACILITIES THAT SUPPORT) ^{INDOOR + OUTDOOR}
- MAKE SAFE SCHOOLS FOR COMMUNITY USE + SCH. ^{DURING SCHOOL + AFTER SCHOOL}
- RECREATION CENTERS
- * SUSTAINABILITY- CONSTRUCTION
- INCREASE SOCIAL SPACES
- * CREATE A SPACE THAT INSPIRE STUDENTS COMM. OWNERSHIP
- CHARACTER + CITIZENSHIP

9/27/16 ST. BODY, MIND, CHARACTER

- * ^{SUPPORT} OUTDOOR ACTIVITY, ^{UP} QUALITY FIELDS + EQUIP.
- VARIETY OF ACTIVITIES
- HAVE ENOUGH SPACE
- * ACTIVE SPACES THAT HEAVILY + ENGAGING
- HANDBALL COURTS
- OUTDOOR STORAGE FOR EQUIPMENT
- WHEN IT IS HOT- COMPUTER ROOM- COOLING RM.
- * SPACES THAT PROVIDE FOR MEMBER RELATED ISSUES ^{STAFFS + MENTORS}
- * SPACES THAT GET STUDENTS INVOLVED
- COMMUNITY + AFTER SCHOOL USE SPACE
- OUTSIDE COVERED PLAY AREAS
- ART PUBLIC PRIDE
- SAFETY - CAMERAS

THANK YOU!